



Revolution Products

Misión Library Furniture 2010 Price List



Revolution Products
109 White Oak Road, Bldg. C1
Greenville, SC 29609
800-241-9810 / Fax: 800-241-9827

Misión

Welcome to **Misión** from Revolution Products. Based in the Arts and Crafts movement of furniture **Misión** will compliment any architectural setting.

Index

- | | | |
|-------|--|------------|
| I. | Terms and Conditions | |
| II. | Misión Reading Tables | Pgs. 3-5 |
| III. | Misión IT Tables with monitor racks | Pgs. 6-7 |
| IV. | Misión IT Workstations with adjustable height work surfaces | Pgs. 8-9 |
| V. | Misión Single Face & Hexagonal Study Carrels | Pg. 10 |
| VI. | Misión Double Face Study Carrels | Pg. 11 |
| VII. | Misión Display Units | Pg. 12 |
| VIII. | Misión End Panels | Pgs. 13-26 |



Misión

Terms of Sale: All prices are FOB Greenville, SC. Net 30 days from date of shipment. All prices are list and subject to change without notice. Interest of 2% per month will be assessed on past due invoices. Possession of price list does not constitute authority to purchase or sell products herein.

Taxes: All applicable taxes are extra. If a client is tax exempt please provide tax certificate.

Ordering: Orders must have all pertinent information provided before they will be processed and entered including model numbers, quantities and finish, laminate and fabric selections where appropriate. Please provide a requested by date, or not to ship before date on your order.

Warranty: All items are warranted for 10 years unless otherwise stated. Warranty is for initial purchaser and only valid as long as the product is owned by original customer. The warranty, which begins at date of manufacture, covers defects in materials and workmanship found during the normal usage of product during the warranty period. Revolution Products will at it's option repair or replace the defective product with a comparable component or product. Warranty does not cover any "Customers Own Material" used in manufacture. Except as stated above, Revolution Products makes no express or implied warranties as to any product and in particular makes no warranty of fitness for any particular use. At Revolution Products option, product repair, or replacement is the customer's exclusive remedy for any and all product defects.

BIFMA and ANSI Testing: All products offered by Revolution Products meet or exceed applicable BIFMA and ANSI testing standards.

New Accounts: New Accounts can only be established with the approval of a Revolution Products representative. New accounts will be subject to special credit reference requirements and deposit terms before they are approved.



Misión

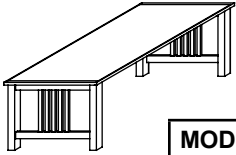

READING TABLES

MODEL NUMBER	DESCRIPTION	LIST PRICE
M-3648-O	Table 36" deep x 48" wide, HPL top 1 1/4" thick with 3/4" wide x 1 5/8" high drop edge banding on all edges in oak, 2 end frames consisting of 2 1/2" solid oak legs, apron and stretcher 2 1/2" high X 1 1/4" thick with 5 each vertical pilasters 1 7/8" wide x 3/4" thick, a ladder keel and metal leg plates add structural support to the table	2334.00
M-3060-O	Table 30" deep x 60" wide, HPL top 1 1/4" thick with 3/4" wide x 1 5/8" high drop edge banding on all edges in oak, 2 end frames consisting of 2 1/2" solid oak legs, apron and stretcher 2 1/2" high X 1 1/4" thick with 5 each vertical pilasters 1 7/8" wide x 3/4" thick, a ladder keel and metal leg plates add structural support to the table	2413.00
M-3660-O	Table 36" deep x 60" wide, HPL top 1 1/4" thick with 3/4" wide x 1 5/8" high drop edge banding on all edges in oak, 2 end frames consisting of 2 1/2" solid oak legs, apron and stretcher 2 1/2" high X 1 1/4" thick with 5 each vertical pilasters 1 7/8" wide x 3/4" thick, a ladder keel and metal leg plates add structural support to the table	2450.00
M-3672-O	Table 36" deep x 72" wide, HPL top 1 1/4" thick with 3/4" wide x 1 5/8" high drop edge banding on all edges in oak, 2 end frames consisting of 2 1/2" solid oak legs, apron and stretcher 2 1/2" high X 1 1/4" thick with 5 each vertical pilasters 1 7/8" wide x 3/4" thick, a ladder keel and metal leg plates add structural support to the table	2577.00
M-3696-O	Table 36" deep x 96" wide, HPL top 1 1/4" thick with 2 5/8" wide edge banding on ends and 1/2" deep edge banding on long edges in oak, 2 end frames consisting of 2 1/2" solid oak legs, apron and stretcher 2 1/2" high X 1 1/4" thick with 5 each vertical pilasters 1 7/8" wide x 3/4" thick, a ladder keel and metal leg plates and structure to the table	3092.00

Misión

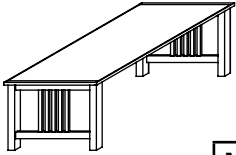

READING TABLES

MODEL NUMBER	DESCRIPTION	LIST PRICE
M-4272-O	Table 42" deep x 72" wide, HPL top 1 1/4" thick with 3/4" wide x 1 5/8" high drop edge banding on all edges in oak, 2 end frames consisting of 2 1/2" solid oak legs, apron and stretcher 2 1/2" high X 1 1/4" thick with 5 each vertical pilasters 1 7/8" wide x 3/4" thick, a ladder keel and metal leg plates add structural support to the table	2989.00
M-4284-O	Table 42" deep x 84" wide, HPL top 1 1/4" thick with 3/4" wide x 1 5/8" high drop edge banding on all edges in oak, 2 end frames consisting of 2 1/2" solid oak legs, apron and stretcher 2 1/2" high X 1 1/4" thick with 5 each vertical pilasters 1 7/8" wide x 3/4" thick, a ladder keel and metal leg plates add structural support to the table	3135.00
M-4296-O	Table 42" deep x 96" wide, HPL top 1 1/4" thick with 3/4" wide x 1 5/8" high drop edge banding on all edges in oak, 2 end frames consisting of 2 1/2" solid oak legs, apron and stretcher 2 1/2" high X 1 1/4" thick with 5 each vertical pilasters 1 7/8" wide x 3/4" thick, a ladder keel and metal leg plates add structural support to the table	3158.00
M-4872-O	Table 48" deep x 72" wide, HPL top 1 1/4" thick with 3/4" wide x 1 5/8" high drop edge banding on all edges in oak, 2 end frames consisting of 2 1/2" solid oak legs, apron and stretcher 2 1/2" high X 1 1/4" thick with 5 each vertical pilasters 1 7/8" wide x 3/4" thick, a ladder keel and metal leg plates add structural support to the table	2989.00
M-4884-O	Table 48" deep x 84" wide, HPL top 1 1/4" thick with 3/4" wide x 1 5/8" high drop edge banding on all edges in oak, 2 end frames consisting of 2 1/2" solid oak legs, apron and stretcher 2 1/2" high X 1 1/4" thick with 5 each vertical pilasters 1 7/8" wide x 3/4" thick, a ladder keel and metal leg plates add structural support to the table	3170.00



Misión

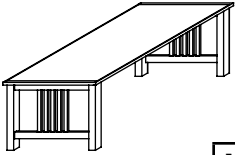

READING TABLES

MODEL NUMBER	DESCRIPTION	LIST PRICE
M-4896-O	Table 48" deep x 96" wide, HPL top 1 1/4" thick with 3/4" wide x 1 5/8" high drop edge banding on all edges in oak, 2 end frames consisting of 2 1/2" solid oak legs, apron and stretcher 2 1/2" high X 1 1/4" thick with 5 each vertical pilasters 1 7/8" wide x 3/4" thick, a ladder keel and metal leg plates add structural support to the table	3207.00
M-4242-O	Table 42" square, HPL top 1 1/4" thick with 3/4" wide x 1 5/8" deep drop edge banding on all edges, 2 1/2" solid oak legs, 2 1/2" high x 1 1/4" thick aprons	1839.00
M-4848-O	Table 48" square, HPL top 1 1/4" thick with 3/4" wide x 1 5/8" deep drop edge banding on all edges, 2 1/2" solid oak legs, 2 1/2" high x 1 1/4" thick aprons	1986.00
M-42R-O	Table 42" round, HPL top 1 1/4" thick with 3/4" wide x 1 5/8" deep drop edge banding on all edges, 2 1/2" square solid oak legs, 2 1/2" high aprons	1839.00
M-48R-O	Table 48" round, HPL top 1 1/4" thick with 3/4" wide x 1 5/8" deep drop edge banding on all edges, 2 1/2" square solid oak legs, 2 1/2" high aprons	2047.00
SUFFIX -M	For maple tables change suffix O to M and add 7 percent	
SUFFIX -C	For cherry tables change suffix O to C and add 20 percent	

Misión

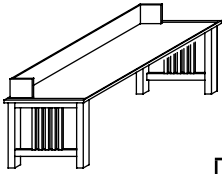

INFORMATION TECHNOLOGY TABLES WITH MONITOR RACKS

MODEL NUMBER	DESCRIPTION	LIST PRICE
M-3036-O-IT	IT table 30" deep x 36" wide, HPL top 1 1/4" thick with 3/4" wide x 1 5/8" high drop edge banding on all edges in oak, 10" high monitor rack across the back extending forward 10" on each end, 2 each end frames consisting of 2 1/2" solid oak legs, apron and stretcher 2 1/2" high X 1 1/4" thick with 5 each vertical pilasters 1 7/8" wide x 3/4" thick, a ladder keel and metal leg plates add structural support to the table	2616.00
M-3048-O-IT	IT table 30" deep x 48" wide, HPL top 1 1/4" thick with 3/4" wide x 1 5/8" high drop edge banding on all edges in oak, 10" high monitor rack across the back extending forward 10" on each end, 2 each end frames consisting of 2 1/2" solid oak legs, apron and stretcher 2 1/2" high X 1 1/4" thick with 5 each vertical pilasters 1 7/8" wide x 3/4" thick, a ladder keel and metal leg plates add structural support to the table	3355.00
M-3060-O-IT	IT table 30" deep x 60" wide, HPL top 1 1/4" thick with 3/4" wide x 1 5/8" high drop edge banding on all edges in oak, 10" high monitor rack across the back extending forward 10" on each end, 2 each end frames consisting of 2 1/2" solid oak legs, apron and stretcher 2 1/2" high X 1 1/4" thick with 5 each vertical pilasters 1 7/8" wide x 3/4" thick, a ladder keel and metal leg plates add structural support to the table	3471.00
M-3072-O-IT2	IT table 30" deep x 72" wide, HPL top 1 1/4" thick with 3/4" wide x 1 5/8" high drop edge banding on all edges in oak, 10" high monitor rack across the back extending forward 10" on each end, and 10" at the center point, dividing the table top into 2 separate work areas, 2 each end frames consisting of 2 1/2" solid oak legs, apron and stretcher 2 1/2" high X 1 1/4" thick with 5 each vertical pilasters 1 7/8" wide x 3/4" thick, a ladder keel and metal leg plates add structural support to the table	3506.00



Misión

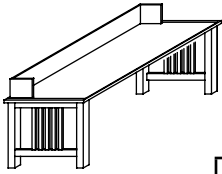

INFORMATION TECHNOLOGY TABLES WITH MONITOR RACKS

MODEL NUMBER	DESCRIPTION	LIST PRICE
M-3096-O-IT2	IT table 30" deep x 96" wide, HPL top 1 1/4" thick with 3/4" wide x 1 5/8" high	4323.00
	drop edge banding on all edges in oak, 10" high monitor rack across the back	
	extending forward 10" on each end, and 10" at the center point, dividing	
	the table top into 2 separate work areas, 2 each end frames consisting of 2 1/2"	
	solid oak legs, apron and stretcher 2 1/2" high X 1 1/4" thick with 5 each	
	vertical pilasters 1 7/8" wide x 3/4" thick, a ladder keel and metal leg plates add	
	structural support to the table	
M-3096-O-IT3	IT table 30" deep x 96" wide, HPL top 1 1/4" thick with 3/4" wide x 1 5/8" high	4369.00
	drop edges banding on all edges in oak, 10" high monitor rack across the back	
	extending forward 10" on each end, and 10" at two points point, dividing	
	the table top into 3 separate work areas, 2 each end frames consisting of 2 1/2"	
	solid oak legs, apron and stretcher 2 1/2" high X 1 1/4" thick with 5 each	
	vertical pilasters 1 7/8" wide x 3/4" thick, a ladder keel and metal leg plates add	
	structural support to the table	
SUFFIX - M	For maple IT tables change suffix O to M and add 7 percent	
SUFFIX - C	For cherry tables change suffix O to C and add 20 percent	



Misión

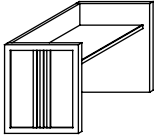

SINGLE FACE INFORMATION TECHNOLOGY WORK STATIONS WITH ADJUSTABLE HEIGHT WORK SURFACE

MODEL NUMBER	DESCRIPTION	LIST PRICE
M-3136-O-ITS	IT work station starter 31" deep x 36" wide x 39" high, 1 7/17" thick end panels	2875.00
	with 2 3/8" solid oak edge banding with vertical slats, adjustable height HPL top	
	1 1/4" thick with 3/4" deep solid oak edge banding on front edge	
M-3136-O-ITS-A	IT work station adder 31" deep x 36" wide x 39" high, 1 1/4" thick intermediate	2080.00
	panel with 1/4" solid oak edge banding, adjustable height HPL work surface	
	1 1/4" thick with 3/4" deep solid oak edge banding on front edge	
M-3148-O-ITS	IT work station starter 31" deep x 48" wide x 39" high, 1 7/16" thick end panels	3369.00
	with 2 3/8" solid oak edge banding with vertical slats, adjustable height HPL top	
	1 1/4" thick with 3/4" deep solid oak edge banding on front edge	
M-3148-O-ITS-A	IT work station adder 31" deep x 48" wide x 39" high, 1 1/4" thick intermediate	2491.00
	panel with 1/4" solid oak edge banding, adjustable height HPL work surface	
	1 1/4" thick with 3/4" deep solid oak edge banding on front edge	
M-3172-O-ITS	IT work station starter 31" deep x 72" wide x 39" high, 1 7/16" thick end panels	4797.00
	with 2 3/8" solid oak edge banding with vertical slats, adjustable height HPL top	
	1 1/4" thick with 3/4" deep solid oak edge banding on front edge and work	
	surface support	
M-3172-O-ITS-A	IT work station adder 31" deep x 72" wide x 39" high, 1 1/4" thick intermediate	3909.00
	panel with 1/4" solid oak edge banding, adjustable height HPL work surface	
	1 1/4" thick with 3/4" deep solid oak edge banding on front edge and work	
	surface support	



Misión

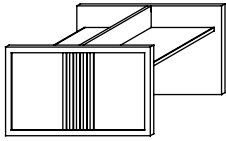

DOUBLE FACE INFORMATION TECHNOLOGY WORK STATIONS WITH ADJUSTABLE HEIGHT WORK SURFACE

MODEL NUMBER	DESCRIPTION	LIST PRICE
M-3136-O-ITDF	Carrel work station, double faced, starter 61" deep x 38" wide x 48" high,	4600.00
	1 7/16" thick end panels with 2 3/8" wide edge banding with 5 each 1 3/4" wide	
	vertical slats, 2 each 1 1/4" thick HPL work surfaces with 3/4" oak edge banding	
	on front edge	
M-3136-O-ITDF-A	Carrel work station, double faced, adder 61" deep x 36 1/2" wide x 48" high, 1 1/4" thick intermediate panel with 1/4" thick edge banding, 2 each 1 1/4" thick	2990.00
	HPL work surfaces with 3/4" thick oak edge banding on front edge	
M-3148-O-ITDF	Carrel work station, double faced, starter 61" deep x 50" wide x 48" high,	5022.00
	1 7/16" thick end panels with 2 3/8" wide edge banding with 5 each 1 3/4" wide	
	vertical slats, 2 each 1 1/4" thick HPL work surfaces with 3/4" oak edge banding	
	on front edge	
M-3148-O-ITDF-A	Carrel work station, double faced, adder 61" deep x 48 1/2" wide x 48" high, 1 1/4" thick intermediate panel with 1/4" thick edge banding, 2 each 1 1/4" thick	3416.00
	HPL work surfaces with 3/4" thick oak edge banding on front edge	
M-3172-O-ITDF	Carrel work station, double faced, starter 61" deep x 74" wide x 48" high,	6730.00
	1 7/16" thick end panels with 2 3/8" wide edge banding with 5 each 1 3/4" wide	
	vertical slats, 2 each 1 1/4" thick HPL work surfaces with 1/2" oak edge banding	
	on front edge and work surface support	
M-3172-O-ITDF-A	Carrel work station, double faced, adder 61" deep x 72 1/2" wide x 48" high, 1 1/4" thick intermediate panel with 1/4" thick edge banding, 2 each 1 1/4" thick	4764.00
	HPL work surfaces with 3/4" thick oak edge banding on front edge and work	
	surface support	
SUFFIX-M	For maple carrels change suffix O to M and add 7 percent.	
SUFFIX-C	For cherry tables change suffix O to C and add 20 percent	



Misión

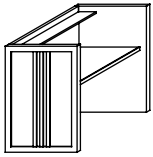

SINGLE FACE & HEXAGONAL STUDY CARRELS

MODEL NUMBER	DESCRIPTION	LIST PRICE
M-3136-O-C	Carrel work station starter 31" deep x 38" wide x 48" high, 1 7/16" thick end panels with 2 3/8" thick solid oak edge banding and 1 3/4" wide vertical slats, 1 1/4" thick HPL work surface with 3/4" deep solid oak edge banding on front edge	2990.00
M-3136-O-C-A	Carrel work station adder 31" deep x 36 1/2" wide x 48" high, 1 1/4" thick intermediate panel with 1/4" thick edge banding, 1 1/4" thick HPL work surface with 3/4" deep solid oak edge banding on front edge	1989.00
M-3150-O-C	Carrel work station starter 31" deep x 50" wide x 48" high, 1 7/16" thick end panels with 2 3/8" thick solid oak edge banding and 1 3/4" wide vertical slats, 1 1/4" thick HPL work surface with 3/4" deep solid oak edge banding on front edge	3313.00
M-3148-O-C-A	Carrel work station adder 31" deep x 48 1/2" wide x 48" high, 1 1/4" thick intermediate panel with 1/4" thick edge banding, 1 1/4" thick HPL work surface with 3/4" deep solid oak edge banding on front edge	2208.00
M-3174-O-C	Carrel work station starter 31" deep x 74" wide x 48" high, 1 7/16" thick end panels with 2 3/8" thick solid oak edge banding and 1 3/4" wide vertical slats, 1 1/4" thick HPL work surface with 3/4" deep solid oak edge banding on front edge and work surface support	4600.00
M-3172-O-C-A	Carrel work station adder 31" deep x 72 1/2" wide x 48" high, 1 1/4" thick intermediate panel with 1/4" thick edge banding, 1 1/4" thick HPL work surface with 3/4" deep solid oak edge banding on front edge and work surface support	3670.00
M-9898-O-HEX	Hexagonal OPAC station with 6 work spaces 98" x 98" with central core for wiring access, 1 1/4" thick HPL work surfaces with 3/4" deep solid oak edge banding on front edge, 1 1/4" thick divider panels with 1/4" solid oak edge banding	10122.00
M-9849-O-1/2HEX	Half hexagonal OPAC station with 3 work spaces 98" x 49" with open central core for wiring access, 1 1/4" thick HPL work surfaces with 3/4" deep solid oak edge banding on front edge, 1 1/4" thick divider panels with 1/4" solid oak edge banding	6556.00

Misión

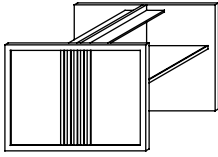

DOUBLE FACE STUDY CARRELS

MODEL NUMBER	DESCRIPTION	LIST PRICE
M-3136-O-CDF	Carrel work station, double faced, starter 61" deep x 38" wide x 48" high, 1 7/16" thick end panels with 2 3/8" wide edge banding with 5 each 1 3/4" wide vertical slats, 2 each 1 1/4" thick HPL work surfaces with 3/4" oak edge banding on front edge	4233.00
M-3136-O-CDF-A	Carrel work station, double faced, adder 61" deep x 36 1/2" wide x 48" high, 1 1/4" thick intermediate panel with 1/4" thick edge banding, 2 each 1 1/4" thick HPL work surfaces with 3/4" thick oak edge banding on front edge	2665.00
M-3148-O-CDF	Carrel work station, double faced, starter 61" deep x 50" wide x 48" high, 1 7/16" thick end panels with 2 3/8" wide edge banding with 5 each 1 3/4" wide vertical slats, 2 each 1 1/4" thick HPL work surfaces with 1/2" oak edge banding on front edge	4767.00
M-3148-O-CDF-A	Carrel work station, double faced, adder 61" deep x 48 1/2" wide x 48" high, 1 1/4" thick intermediate panel with 1/4" thick edge banding, 2 each 1 1/4" thick HPL work surfaces with 3/4" thick oak edge banding on front edge	3151.00
M-3172-O-CDF	Carrel work station, double faced, starter 61" deep x 74" wide x 48" high, 1 7/16" thick end panels with 2 3/8" wide edge banding with 5 each 1 3/4" wide vertical slats, 2 each 1 1/4" thick HPL work surfaces with 3/4" oak edge banding on front edge and work surface support	6545.00
M-3172-O-CDF-A	Carrel work station, double faced, adder 61" deep x 72 1/2" wide x 48" high, 1 1/4" thick intermediate panel with 1/4" thick edge banding, 2 each 1 1/4" thick HPL work surfaces with 3/4" thick oak edge banding on front edge and work surface support	4763.00
SUFFIX-M	For maple carrels change suffix O to M and add 7 percent.	
SUFFIX-C	For cherry tables change suffix O to C and add 20 percent	



Misión

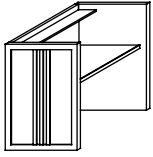

DISPLAY UNITS

MODEL NUMBER	DESCRIPTION	LIST PRICE
M-AS-3045-O	Atlas stand with 2 3/8" edge banding on end panels with vertical slats with 5 each pull out shelves	3661.00
M-DS-2445-O	Dictionary stand with 2 3/8" edge banding on end panels with vertical slats with base shelf and 1 adjustable shelf	2955.00
M-TI-72-DFT-O	Index table double faced, double tier 49" deep x 72" wide x 50" high, HPL top 1 1/4" thick with 3/4" wide x 1 5/8" high drop edge banding on all edges, 2 each end frames consisting of 2 1/2" solid oak legs, 2 1/2" high apron and stretcher with 5 each vertical pilasters 1 7/8" wide x 3/4" thick, double tier index rack with removable shelves, a ladder keel and metal leg plates for structural support	4317.00
M-TI-90-DFT-O	Index table double faced, double tier 49" deep x 90" wide x 50" high, HPL top 1 1/4" thick with 3/4" wide x 1 5/8" high drop edge banding on all edges, 2 each end frames consisting of 2 1/2" solid oak legs, 2 1/2" high apron and stretcher with 5 each vertical pilasters 1 7/8" wide x 3/4" thick, double tier index rack with removable shelves, a ladder keel and metal leg plates for structural support	5395.00
M-6331-DSP-O	Display table 63 1/2" wide x 31" deep x 38 11/16" high, HPL top 1 1/4" thick with 3/4" wide x 1 5/8" high drop edge banding on all edges, 2 each end frames consisting of 2 1/2" solid oak legs, 2 1/2" high apron and stretcher with 5 each vertical pilasters 1 7/8" wide x 3/4" thick, a ladder keel and metal leg plates for structural support glass case to be 59" wide x 29" deep x 9 11/16" high	6455.00
SUFFIX-M	For maple display products change suffix O to M and add 7 percent	
SUFFIX-C	For cherry tables change suffix O to C and add 20 percent	



Misión

END PANELS IN OAK

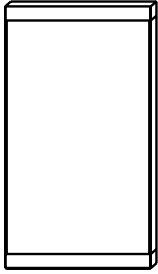

MODEL NUMBER	DESCRIPTION	LIST PRICE
M-4412-DF-O	End panel 44" high x 12" deep, 1 1/8" thick with 2 3/8" solid oak edge banding at top and bottom with 1/4" thick solid oak edge banding on vertical edges	482.00
M-4413-DF-O	End panel 44" high x 13" deep, 1 1/8" thick with 2 3/8" solid oak edge banding at top and bottom with 1/4" thick solid oak edge banding on vertical edges	500.00
M-4414-DF-O	End panel 44" high x 14" deep, 1 1/8" thick with 2 3/8" solid oak edge banding at top and bottom with 1/4" thick solid oak edge banding on vertical edges	503.00
M-4416-DF-O	End panel 44" high x 16" deep, 1 1/8" thick with 2 3/8" solid oak edge banding at top and bottom with 1/4" thick solid oak edge banding on vertical edges	534.00
M-4418-DF-O	End panel 44" high x 18" deep, 1 1/8" thick with 2 3/8" solid oak edge banding at top and bottom with 1/4" thick solid oak edge banding on vertical edges	546.00
M-4420-DF-O	End panel 44" high x 20" deep, 1 1/8" thick with 2 3/8" solid oak edge banding at top and bottom with 1/4" thick solid oak edge banding on vertical edges	558.00
M-4422-DF-O	End panel 44" high x 22" deep, 1 1/8" thick with 2 3/8" solid oak edge banding at top and bottom with 1/4" thick solid oak edge banding on vertical edges	638.00
M-4424-DF-O	End panel 44" high x 24" deep, 1 1/8" thick with 2 3/8" solid oak edge banding at top and bottom with 1/4" thick solid oak edge banding on vertical edges	649.00
M-4425-DF-O	End panel 44" high x 25" deep, 1 1/8" thick with 2 3/8" solid oak edge banding at top and bottom with 1/4" thick solid oak edge banding on vertical edges	691.00
M-4428-DF-O	End panel 44" high x 28" deep, 1 1/8" thick with 2 3/8" solid oak edge banding at top and bottom with 1/4" thick solid oak edge banding on vertical edges	695.00
M-4432-DF-O	End panel 44" high x 32" deep, 1 1/8" thick with 2 3/8" solid oak edge banding at top and bottom with 1/4" thick solid oak edge banding on vertical edges	809.00
M-4812-DF-O	End panel 48" high x 12" deep, 1 1/8" thick with 2 3/8" solid oak edge banding at top and bottom with 1/4" thick solid oak edge banding on vertical edges	482.00
M-4813-DF-O	End panel 48" high x 13" deep, 1 1/8" thick with 2 3/8" solid oak edge banding at top and bottom with 1/4" thick solid oak edge banding on vertical edges	500.00



Misión

END PANELS IN OAK

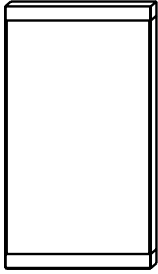

MODEL NUMBER	DESCRIPTION	LIST PRICE
M-4814-DF-O	End panel 48" high x 14" deep, 1 1/8" thick with 2 3/8" solid oak edge banding at top and bottom with 1/4" thick solid oak edge banding on vertical edges	503.00
M-4816-DF-O	End panel 48" high x 16" deep, 1 1/8" thick with 2 3/8" solid oak edge banding at top and bottom with 1/4" thick solid oak edge banding on vertical edges	534.00
M-4818-DF-O	End panel 48" high x 18" deep, 1 1/8" thick with 2 3/8" solid oak edge banding at top and bottom with 1/4" thick solid oak edge banding on vertical edges	546.00
M-4820-DF-O	End panel 48" high x 20" deep, 1 1/8" thick with 2 3/8" solid oak edge banding at top and bottom with 1/4" thick solid oak edge banding on vertical edges	558.00
M-4822-DF-O	End panel 48" high x 22" deep, 1 1/8" thick with 2 3/8" solid oak edge banding at top and bottom with 1/4" thick solid oak edge banding on vertical edges	638.00
M-4824-DF-O	End panel 48" high x 24" deep, 1 1/8" thick with 2 3/8" solid oak edge banding at top and bottom with 1/4" thick solid oak edge banding on vertical edges	649.00
M-4825-DF-O	End panel 48" high x 25" deep, 1 1/8" thick with 2 3/8" solid oak edge banding at top and bottom with 1/4" thick solid oak edge banding on vertical edges	691.00
M-4828-DF-O	End panel 48" high x 28" deep, 1 1/8" thick with 2 3/8" solid oak edge banding at top and bottom with 1/4" thick solid oak edge banding on vertical edges	695.00
M-4832-DF-O	End panel 48" high x 32" deep, 1 1/8" thick with 2 3/8" solid oak edge banding at top and bottom with 1/4" thick solid oak edge banding on vertical edges	809.00
M-5012-DF-O	End panel 50" high x 12" deep, 1 1/8" thick with 2 3/8" solid oak edge banding at top and bottom with 1/4" thick solid oak edge banding on vertical edges	516.00
M-5013-DF-O	End panel 50" high x 13" deep, 1 1/8" thick with 2 3/8" solid oak edge banding at top and bottom with 1/4" thick solid oak edge banding on vertical edges	537.00
M-5014-DF-O	End panel 50" high x 14" deep, 1 1/8" thick with 2 3/8" solid oak edge banding at top and bottom with 1/4" thick solid oak edge banding on vertical edges	542.00
M-5016-DF-O	End panel 50" high x 16" deep, 1 1/8" thick with 2 3/8" solid oak edge banding at top and bottom with 1/4" thick solid oak edge banding on vertical edges	568.00



Misión

END PANELS IN OAK

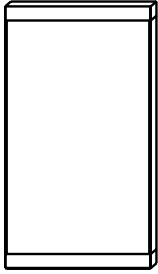

MODEL NUMBER	DESCRIPTION	LIST PRICE
M-5018-DF-O	End panel 50" high x 18" deep, 1 1/8" thick with 2 3/8" solid oak edge banding at top and bottom with 1/4" thick solid oak edge banding on vertical edges	580.00
M-5020-DF-O	End panel 50" high x 20" deep, 1 1/8" thick with 2 3/8" solid oak edge banding at top and bottom with 1/4" thick solid oak edge banding on vertical edges	591.00
M-5022-DF-O	End panel 50" high x 22" deep, 1 1/8" thick with 2 3/8" solid oak edge banding at top and bottom with 1/4" thick solid oak edge banding on vertical edges	672.00
M-5024-DF-O	End panel 50" high x 24" deep, 1 1/8" thick with 2 3/8" solid oak edge banding at top and bottom with 1/4" thick solid oak edge banding on vertical edges	684.00
M-5025-DF-O	End panel 50" high x 25" deep, 1 1/8" thick with 2 3/8" solid oak edge banding at top and bottom with 1/4" thick solid oak edge banding on vertical edges	725.00
M-5028-DF-O	End panel 50" high x 28" deep, 1 1/8" thick with 2 3/8" solid oak edge banding at top and bottom with 1/4" thick solid oak edge banding on vertical edges	728.00
M-5032-DF-O	End panel 50" high x 32" deep, 1 1/8" thick with 2 3/8" solid oak edge banding at top and bottom with 1/4" thick solid oak edge banding on vertical edges	843.00
M-6612-DF-O	End panel 66" high x 12" deep, 1 1/8" thick with 2 3/8" solid oak edge banding at top and bottom with 1/4" thick solid oak edge banding on vertical edges	542.00
M-6613-DF-O	End panel 66" high x 13" deep, 1 1/8" thick with 2 3/8" solid oak edge banding at top and bottom with 1/4" thick solid oak edge banding on vertical edges	568.00
M-6614-DF-O	End panel 66" high x 14" deep, 1 1/8" thick with 2 3/8" solid oak edge banding at top and bottom with 1/4" thick solid oak edge banding on vertical edges	575.00
M-6616-DF-O	End panel 66" high x 16" deep, 1 1/8" thick with 2 3/8" solid oak edge banding at top and bottom with 1/4" thick solid oak edge banding on vertical edges	638.00
M-6618-DF-O	End panel 66" high x 18" deep, 1 1/8" thick with 2 3/8" solid oak edge banding at top and bottom with 1/4" thick solid oak edge banding on vertical edges	649.00
M-6620-DF-O	End panel 66" high x 20" deep, 1 1/8" thick with 2 3/8" solid oak edge banding at top and bottom with 1/4" thick solid oak edge banding on vertical edges	590.00



Misión

END PANELS IN OAK

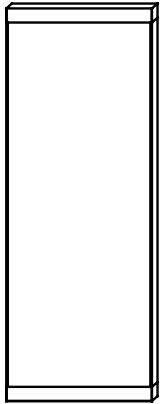

MODEL NUMBER	DESCRIPTION	LIST PRICE
M-6622-DF-O	End panel 66" high x 22" deep, 1 1/8" thick with 2 3/8" solid oak edge banding at top and bottom with 1/4" thick solid oak edge banding on vertical edges	764.00
M-6624-DF-O	End panel 66" high x 24" deep, 1 1/8" thick with 2 3/8" solid oak edge banding at top and bottom with 1/4" thick solid oak edge banding on vertical edges	775.00
M-6625-DF-O	End panel 66" high x 25" deep, 1 1/8" thick with 2 3/8" solid oak edge banding at top and bottom with 1/4" thick solid oak edge banding on vertical edges	820.00
M-6628-DF-O	End panel 66" high x 28" deep, 1 1/8" thick with 2 3/8" solid oak edge banding at top and bottom with 1/4" thick solid oak edge banding on vertical edges	827.00
M-6632-DF-O	End panel 66" high x 32" deep, 1 1/8" thick with 2 3/8" solid oak edge banding at top and bottom with 1/4" thick solid oak edge banding on vertical edges	898.00
M-7812-DF-O	End panel 78" high x 12" deep, 1 1/8" thick with 2 3/8" solid oak edge banding at top and bottom with 1/4" thick solid oak edge banding on vertical edges	561.00
M-7813-DF-O	End panel 78" high x 13" deep, 1 1/8" thick with 2 3/8" solid oak edge banding at top and bottom with 1/4" thick solid oak edge banding on vertical edges	616.00
M-7814-DF-O	End panel 78" high x 14" deep, 1 1/8" thick with 2 3/8" solid oak edge banding at top and bottom with 1/4" thick solid oak edge banding on vertical edges	628.00
M-7816-DF-O	End panel 78" high x 16" deep, 1 1/8" thick with 2 3/8" solid oak edge banding at top and bottom with 1/4" thick solid oak edge banding on vertical edges	672.00
M-7818-DF-O	End panel 78" high x 18" deep, 1 1/8" thick with 2 3/8" solid oak edge banding at top and bottom with 1/4" thick solid oak edge banding on vertical edges	684.00
M-7820-DF-O	End panel 78" high x 20" deep, 1 1/8" thick with 2 3/8" solid oak edge banding at top and bottom with 1/4" thick solid oak edge banding on vertical edges	694.00
M-7822-DF-O	End panel 78" high x 22" deep, 1 1/8" thick with 2 3/8" solid oak edge banding at top and bottom with 1/4" thick solid oak edge banding on vertical edges	774.00
M-7824-DF-O	End panel 78" high x 24" deep, 1 1/8" thick with 2 3/8" solid oak edge banding at top and bottom with 1/4" thick solid oak edge banding on vertical edges	785.00



Misión

END PANELS IN OAK



MODEL NUMBER	DESCRIPTION	LIST PRICE
M-7825-DF-O	End panel 78" high x 25" deep, 1 1/8" thick with 2 3/8" solid oak edge banding at top and bottom with 1/4" thick solid oak edge banding on vertical edges	785.00
M-7828-DF-O	End panel 78" high x 28" deep, 1 1/8" thick with 2 3/8" solid oak edge banding at top and bottom with 1/4" thick solid oak edge banding on vertical edges	797.00
M-7832-DF-O	End panel 78" high x 32" deep, 1 1/8" thick with 2 3/8" solid oak edge banding at top and bottom with 1/4" thick solid oak edge banding on vertical edges	898.00
M-8412-DF-O	End panel 84" high x 12" deep, 1 1/8" thick with 2 3/8" solid oak edge banding at top and bottom with 1/4" thick solid oak edge banding on vertical edges	619.00
M-8413-DF-O	End panel 84" high x 13" deep, 1 1/8" thick with 2 3/8" solid oak edge banding at top and bottom with 1/4" thick solid oak edge banding on vertical edges	672.00
M-8414-DF-O	End panel 84" high x 14" deep, 1 1/8" thick with 2 3/8" solid oak edge banding at top and bottom with 1/4" thick solid oak edge banding on vertical edges	677.00
M-8416-DF-O	End panel 84" high x 16" deep, 1 1/8" thick with 2 3/8" solid oak edge banding at top and bottom with 1/4" thick solid oak edge banding on vertical edges	725.00
M-8418-DF-O	End panel 84" high x 18" deep, 1 1/8" thick with 2 3/8" solid oak edge banding at top and bottom with 1/4" thick solid oak edge banding on vertical edges	735.00
M-8420-DF-O	End panel 84" high x 20" deep, 1 1/8" thick with 2 3/8" solid oak edge banding at top and bottom with 1/4" thick solid oak edge banding on vertical edges	748.00
M-8422-DF-O	End panel 84" high x 22" deep, 1 1/8" thick with 2 3/8" solid oak edge banding at top and bottom with 1/4" thick solid oak edge banding on vertical edges	843.00
M-8424-DF-O	End panel 84" high x 24" deep, 1 1/8" thick with 2 3/8" solid oak edge banding at top and bottom with 1/4" thick solid oak edge banding on vertical edges	848.00
M-8425-DF-O	End panel 84" high x 25" deep, 1 1/8" thick with 2 3/8" solid oak edge banding at top and bottom with 1/4" thick solid oak edge banding on vertical edges	930.00
M-8428-DF-O	End panel 84" high x 28" deep, 1 1/8" thick with 2 3/8" solid oak edge banding at top and bottom with 1/4" thick solid oak edge banding on vertical edges	941.00



Misión

END PANELS IN OAK

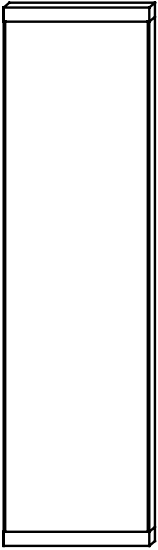

MODEL NUMBER	DESCRIPTION	LIST PRICE
M-8432-DF-O	End panel 84" high x 32" deep, 1 1/8" thick with 2 3/8" solid oak edge banding at top and bottom with 1/4" thick solid oak edge banding on vertical edges	988.00
M-9012-DF-O	End panel 90" high x 12" deep, 1 1/8" thick with 2 3/8" solid oak edge banding at top and bottom with 1/4" thick solid oak edge banding on vertical edges	619.00
M-9013-DF-O	End panel 90" high x 13" deep, 1 1/8" thick with 2 3/8" solid oak edge banding at top and bottom with 1/4" thick solid oak edge banding on vertical edges	672.00
M-9014-DF-O	End panel 90" high x 14" deep, 1 1/8" thick with 2 3/8" solid oak edge banding at top and bottom with 1/4" thick solid oak edge banding on vertical edges	677.00
M-9016-DF-O	End panel 90" high x 16" deep, 1 1/8" thick with 2 3/8" solid oak edge banding at top and bottom with 1/4" thick solid oak edge banding on vertical edges	725.00
M-9018-DF-O	End panel 90" high x 18" deep, 1 1/8" thick with 2 3/8" solid oak edge banding at top and bottom with 1/4" thick solid oak edge banding on vertical edges	736.00
M-9020-DF-O	End panel 90" high x 20" deep, 1 1/8" thick with 2 3/8" solid oak edge banding at top and bottom with 1/4" thick solid oak edge banding on vertical edges	748.00
M-9022-DF-O	End panel 90" high x 22" deep, 1 1/8" thick with 2 3/8" solid oak edge banding at top and bottom with 1/4" thick solid oak edge banding on vertical edges	843.00
M-9024-DF-O	End panel 90" high x 24" deep, 1 1/8" thick with 2 3/8" solid oak edge banding at top and bottom with 1/4" thick solid oak edge banding on vertical edges	848.00
M-9025-DF-O	End panel 90" high x 25" deep, 1 1/8" thick with 2 3/8" solid oak edge banding at top and bottom with 1/4" thick solid oak edge banding on vertical edges	930.00
M-9028-DF-O	End panel 90" high x 28" deep, 1 1/8" thick with 2 3/8" solid oak edge banding at top and bottom with 1/4" thick solid oak edge banding on vertical edges	941.00
M-9032-DF-O	End panel 90" high x 32" deep, 1 1/8" thick with 2 3/8" solid oak edge banding at top and bottom with 1/4" thick solid oak edge banding on vertical edges	988.00



Misión

END PANELS IN OAK

SUFFIX-M	For maple end panels change suffix O to M and add 7 percent
SUFFIX-C	For cherry end panels change suffix O to C and add 20 percent

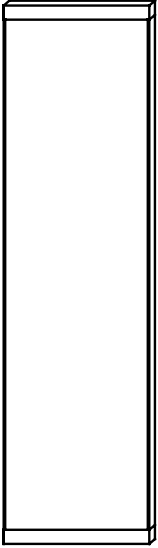

Misión

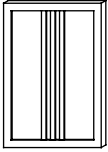

END PANELS WITH VERTICAL SLATS IN OAK

MODEL NUMBER	DESCRIPTION	LIST PRICE
MA-4412-DF-O	End panel 44" high x 12" deep, 1 1/4" thick x 1 3/4" wide solid oak edge	863.00
	banding all 4 sides with vertical slats	
MA-4413-DF-O	End panel 44" high x 13" deep, 1 1/4" thick x 1 3/4" wide solid oak edge	880.00
	banding all 4 sides with vertical slats	
MA-4414-DF-O	End panel 44" high x 14" deep, 1 1/4" thick x 1 3/4" wide solid oak edge	902.00
	banding all 4 sides with vertical slats	
MA-4416-DF-O	End panel 44" high x 16" deep, 1 1/4" thick x 1 3/4" wide solid oak edge	958.00
	banding all 4 sides with vertical slats	
MA-4418-DF-O	End panel 44" high x 18" deep, 1 1/4" thick x 1 3/4" wide solid oak edge	978.00
	banding all 4 sides with vertical slats	
MA-4420-DF-O	End panel 44" high x 20" deep, 1 1/4" thick x 1 3/4" wide solid oak edge	999.00
	banding all 4 sides with vertical slats	
MA-4422-DF-O	End panel 44" high x 22" deep, 1 1/4" thick x 1 3/4" wide solid oak edge	1144.00
	banding all 4 sides with vertical slats	
MA-4424-DF-O	End panel 44" high x 24" deep, 1 1/4" thick x 1 3/4" wide solid oak edge	1163.00
	banding all 4 sides with vertical slats	
MA-4425-DF-O	End panel 44" high x 25" deep, 1 1/4" thick x 1 3/4" wide solid oak edge	1237.00
	banding all 4 sides with vertical slats	
MA-4428-DF-O	End panel 44" high x 28" deep, 1 1/4" thick x 1 3/4" wide solid oak edge	1246.00
	banding all 4 sides with vertical slats	
MA-4432-DF-O	End panel 44" high x 32" deep, 1 1/4" thick x 1 3/4" wide solid oak edge	1449.00
	banding all 4 sides with vertical slats	
MA-4812-DF-O	End panel 48" high x 12" deep, 1 1/4" thick x 1 3/4" wide solid oak edge	864.00
	banding all 4 sides with vertical slats	
MA-4813-DF-O	End panel 48" high x 13" deep, 1 1/4" thick x 1 3/4" wide solid oak edge	897.00
	banding all 4 sides with vertical slats	

Misión

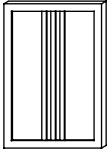

END PANELS WITH VERTICAL SLATS IN OAK

MODEL NUMBER	DESCRIPTION	LIST PRICE
MA-4814-DF-O	End panel 48" high x 14" deep, 1 1/4" thick x 1 3/4" wide solid oak edge	902.00
	banding all 4 sides with vertical slats	
MA-4816-DF-O	End panel 48" high x 16" deep, 1 1/4" thick x 1 3/4" wide solid oak edge	958.00
	banding all 4 sides with vertical slats	
MA-4818-DF-O	End panel 48" high x 18" deep, 1 1/4" thick x 1 3/4" wide solid oak edge	978.00
	banding all 4 sides with vertical slats	
MA-4820-DF-O	End panel 48" high x 20" deep, 1 1/4" thick x 1 3/4" wide solid oak edge	999.00
	banding all 4 sides with vertical slats	
MA-4822-DF-O	End panel 48" high x 22" deep, 1 1/4" thick x 1 3/4" wide solid oak edge	1143.00
	banding all 4 sides with vertical slats	
MA-4824-DF-O	End panel 48" high x 24" deep, 1 1/4" thick x 1 3/4" wide solid oak edge	1164.00
	banding all 4 sides with vertical slats	
MA-4825-DF-O	End panel 48" high x 25" deep, 1 1/4" thick x 1 3/4" wide solid oak edge	1237.00
	banding all 4 sides with vertical slats	
MA-4828-DF-O	End panel 48" high x 28" deep, 1 1/4" thick x 1 3/4" wide solid oak edge	1246.00
	banding all 4 sides with vertical slats	
MA-4832-DF-O	End panel 48" high x 32" deep, 1 1/4" thick x 1 3/4" wide solid oak edge	1449.00
	banding all 4 sides with vertical slats	
MA-5012-DF-O	End panel 50" high x 12" deep, 1 1/4" thick x 1 3/4" wide solid oak edge	923.00
	banding all 4 sides with vertical slats	
MA-5013-DF-O	End panel 50" high x 13" deep, 1 1/4" thick x 1 3/4" wide solid oak edge	963.00
	banding all 4 sides with vertical slats	
MA-5014-DF-O	End panel 50" high x 14" deep, 1 1/4" thick x 1 3/4" wide solid oak edge	968.00
	banding all 4 sides with vertical slats	
MA-5016-DF-O	End panel 50" high x 16" deep, 1 1/4" thick x 1 3/4" wide solid oak edge	1019.00
	banding all 4 sides with vertical slats	



Misión

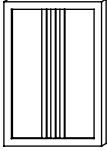

END PANELS WITH VERTICAL SLATS IN OAK

MODEL NUMBER	DESCRIPTION	LIST PRICE
MA-5018-DF-O	End panel 50" high x 18" deep, 1 1/4" thick x 1 3/4" thick solid oak edge	1038.00
	banding all 4 sides and vertical slats	
MA-5020-DF-O	End panel 50" high x 20" deep, 1 1/4" thick x 1 3/4" thick solid oak edge	1059.00
	banding all 4 sides and vertical slats	
MA-5022-DF-O	End panel 50" high x 22" deep, 1 1/4" thick x 1 3/4" wide solid oak edge	1204.00
	banding all 4 sides and vertical slats	
MA-5024-DF-O	End panel 50" high x 24" deep, 1 1/4" thick x 1 3/4" wide solid oak edge	1223.00
	banding all 4 sides and vertical slats	
MA-5025-DF-O	End panel 50" high x 25" deep, 1 1/4" thick x 1 3/4" wide solid oak edge	1299.00
	banding all 4 sides and vertical slats	
MA-5028-DF-O	End panel 50" high x 28" deep, 1 1/4" thick x 1 3/4" wide solid oak edge	1307.00
	banding all 4 sides and vertical slats	
MA-5032-DF-O	End panel 50" high x 32" deep, 1 1/4" thick x 1 3/4" wide solid oak edge	1509.00
	banding all 4 sides and vertical slats	
MA-6612-DF-O	End panel 66" high x 12" deep, 1 1/4" thick x 1 3/4" wide solid oak edge	971.00
	banding all 4 sides and vertical slats	
MA-6613-DF-O	End panel 66" high x 13" deep, 1 1/4" thick x 1 3/4" wide solid oak edge	1019.00
	banding all 4 sides and vertical slats	
MA-6614-DF-O	End panel 66" high x 14" deep, 1 1/4" thick x 1 3/4" wide solid oak edge	1031.00
	banding all 4 sides and vertical slats	
MA-6616-DF-O	End panel 66" high x 16" deep, 1 1/4" thick x 1 3/4" wide solid oak edge	1144.00
	banding all 4 sides and vertical slats	
MA-6618-DF-O	End panel 66" high x 18" deep, 1 1/4" thick x 1 3/4" wide solid oak edge	1164.00
	banding all 4 sides and vertical slats	
MA-6620-DF-O	End panel 66" high x 20" deep, 1 1/4" thick x 1 3/4" wide solid oak edge	804.00
	banding all 4 sides and vertical slats	



Misión

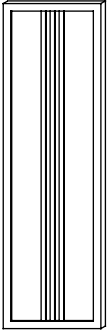

END PANELS WITH VERTICAL SLATS IN OAK

MODEL NUMBER	DESCRIPTION	LIST PRICE
MA-6622-DF-O	End panel 66" high x 22" deep, 1 1/4" thick x 1 3/4" wide solid oak edge	1368.00
	banding all 4 sides with vertical slats	
MA-6624-DF-O	End panel 66" high x 24" deep, 1 1/4" thick x 1 3/4" wide solid oak edge	1390.00
	banding all 4 sides with vertical slats	
MA-6625-DF-O	End panel 66" high x 25" deep, 1 1/4" thick x 1 3/4" wide solid oak edge	1470.00
	banding all 4 sides with vertical slats	
MA-6628-DF-O	End panel 66" high x 28" deep, 1 1/4" thick x 1 3/4" wide solid oak edge	1481.00
	banding all 4 sides with vertical slats	
MA-6632-DF-O	End panel 66" high x 32" deep, 1 1/4" thick x 1 3/4" wide solid oak edge	1608.00
	banding all 4 sides with vertical slats	
MA-7812-DF-O	End panel 78" high x 12" deep, 1 1/4" thick x 1 3/4" wide solid oak edge	1004.00
	banding all 4 sides with vertical slats	
MA-7813-DF-O	End panel 78" high x 13" deep, 1 1/4" thick x 1 3/4" wide solid oak edge	1105.00
	banding all 4 sides with vertical slats	
MA-7814-DF-O	End panel 78" high x 14" deep, 1 1/4" thick x 1 3/4" wide solid oak edge	1137.00
	banding all 4 sides with vertical slats	
MA-7816-DF-O	End panel 78" high x 16" deep, 1 1/4" thick x 1 3/4" wide solid oak edge	1170.00
	banding all 4 sides with vertical slats	
MA-7818-DF-O	End panel 78" high x 18" deep, 1 1/4" thick x 1 3/4" wide solid oak edge	1189.00
	banding all 4 sides with vertical slats	
MA-7820-DF-O	End panel 78" high x 20" deep, 1 1/4" thick x 1 3/4" wide solid oak edge	1209.00
	banding all 4 sides with vertical slats	
MA-7822-DF-O	End panel 78" high x 22" deep, 1 1/4" thick x 1 3/4" wide solid oak edge	1347.00
	banding all 4 sides with vertical slats	
MA-7824-DF-O	End panel 78" high x 24" deep, 1 1/4" thick x 1 3/4" wide solid oak edge	1366.00
	banding all 4 sides with vertical slats	



Misión

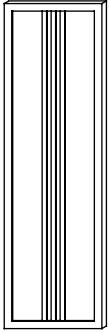

END PANELS WITH VERTICAL SLATS IN OAK

MODEL NUMBER	DESCRIPTION	LIST PRICE
MA-7825-DF-O	End panel 78" high x 25" deep, 1 1/4" thick x 1 3/4" wide solid oak edge banding on all 4 sides with vertical slats	1366.00
MA-7828-DF-O	End panel 78" high x 28" deep, 1 1/4" thick x 1 3/4" wide solid oak edge banding on all 4 sides with vertical slats	1386.00
MA-7832-DF-O	End panel 78" high x 32" deep, 1 1/4" thick x 1 3/4" wide solid oak edge banding on all 4 sides with vertical slats	1562.00
MA-8412-DF-O	End panel 84" high x 12" deep, 1 1/4" thick x 1 3/4" wide solid oak edge banding on all 4 sides with vertical slats	1062.00
MA-8413-DF-O	End panel 84" high x 13" deep, 1 1/4" thick x 1 3/4" wide solid oak edge banding on all 4 sides with vertical slats	1143.00
MA-8414-DF-O	End panel 84" high x 14" deep, 1 1/4" thick x 1 3/4" wide solid oak edge banding on all 4 sides with vertical slats	1151.00
MA-8416-DF-O	End panel 84" high x 16" deep, 1 1/4" thick x 1 3/4" wide solid oak edge banding on all 4 sides with vertical slats	1232.00
MA-8418-DF-O	End panel 84" high x 18" deep, 1 1/4" thick x 1 3/4" wide solid oak edge banding on all 4 sides with vertical slats	1251.00
MA-8420-DF-O	End panel 84" high x 20" deep, 1 1/4" thick x 1 3/4" wide solid oak edge banding on all 4 sides with vertical slats	1271.00
MA-8422-DF-O	End panel 84" high x 22" deep, 1 1/4" thick x 1 3/4" wide solid oak edge banding on all 4 sides with vertical slats	1433.00
MA-8424-DF-O	End panel 84" high x 24" deep, 1 1/4" thick x 1 3/4" wide solid oak edge banding on all 4 edges with vertical slats	1442.00
MA-8425-DF-O	End panel 84" high x 25" deep, 1 1/4" thick x 1 3/4" wide solid oak edge banding on all 4 edges with vertical slats	1580.00
MA-8428-DF-O	End panel 84" high x 28" deep, 1 1/4" thick x 1 3/4" wide solid oak edge banding on all 4 edges with vertical slats	1600.00



Misión

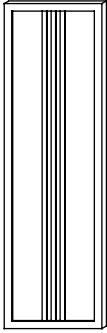

END PANELS WITH VERTICAL SLATS IN OAK

MODEL NUMBER	DESCRIPTION	LIST PRICE
MA-8432-DF-O	End panel 84" high x 32" deep, 1 1/4" thick x 1 3/4" wide solid oak edge	1679.00
	banding on all 4 sides with vertical slats	
MA-9012-DF-O	End panel 90" high x 12" deep, 1 1/4" thick x 1 3/4" wide solid oak edge	1106.00
	banding on all 4 sides with vertical slats	
MA-9013-DF-O	End panel 90" high x 13" deep, 1 1/4" thick x 1 3/4" wide solid oak edge	1141.00
	banding on all 4 sides with vertical slats	
MA-9014-DF-O	End panel 90" high x 14" deep, 1 1/4" thick x 1 3/4" wide solid oak edge	1149.00
	banding on all 4 sides with vertical slats	
MA-9016-DF-O	End panel 90" high x 16" deep, 1 1/4" thick x 1 3/4" wide solid oak edge	1232.00
	banding on all 4 sides with vertical slats	
MA-9018-DF-O	End panel 90" high x 18" deep, 1 1/4" thick x 1 3/4" wide solid oak edge	1252.00
	banding on all 4 sides with vertical slats	
MA-9020-DF-O	End panel 90" high x 20" deep, 1 1/4" thick x 1 3/4" wide solid oak edge	1271.00
	banding on all 4 sides with vertical slats	
MA-9022-DF-O	End panel 90" high x 22" deep, 1 1/4" thick x 1 3/4" wide solid oak edge	1434.00
	banding on all 4 sides with vertical slats	
MA-9024-DF-O	End panel 90" high x 24" deep, 1 1/4" thick x 1 3/4" wide solid oak edge	1442.00
	banding on all 4 sides with vertical slats	
MA-9025-DF-O	End panel 90" high x 25" deep, 1 1/4" thick x 1 3/4" wide solid oak edge	1580.00
	banding on all 4 sides with vertical slats	
MA-9028-DF-O	End panel 90" high x 28" deep, 1 1/4" thick x 1 3/4" wide solid oak edge	1600.00
	banding on all 4 sides with vertical slats	
MA-9032-DF-O	End panel 90" high x 32" deep, 1 1/4" thick x 1 3/4" wide solid oak edge	1679.00
	banding on all 4 sides with vertical slats	



Misión

END PANELS WITH VERTICAL SLATS IN OAK

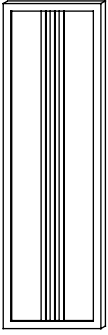

SUFFIX-M	For maple end panels change suffix O to M and add 7 percent
SUFFIX-C	For cherry end panels change suffix O to C and add 20 percent